



DHOLLANDIA



POCKET GUIDE PRODUCT RANGE 2015



DHOLLANDIA

**POCKET GUIDE
PRODUCT RANGE 2015**



Content list

DHOLLANDIA facts & figures	Pg 3
6 good reasons to buy DHOLLANDIA	Pg 4
Best possible protection for your investment	Pg 6
Different types of RIDE	Pg 8
Control units for all applications...	Pg 10
... and an endless list of options to choose from	Pg 12
Professional service network Original spare parts	Pg 13
Reading help	Pg 14
Chapter 1 • Passenger lifts	Pg 16
Chapter 2 • Lifts for factory built panel vans	Pg 42
Chapter 3 • Cantilever lifts	Pg 66
Chapter 4 • Slider lifts	Pg 100
Chapter 5 • Fold-away lifts	Pg 126
Chapter 6 • Special hydraulic applications	Pg 144
Chapter 7 • Column lifts	Pg 162

DHOLLANDIA facts & figures

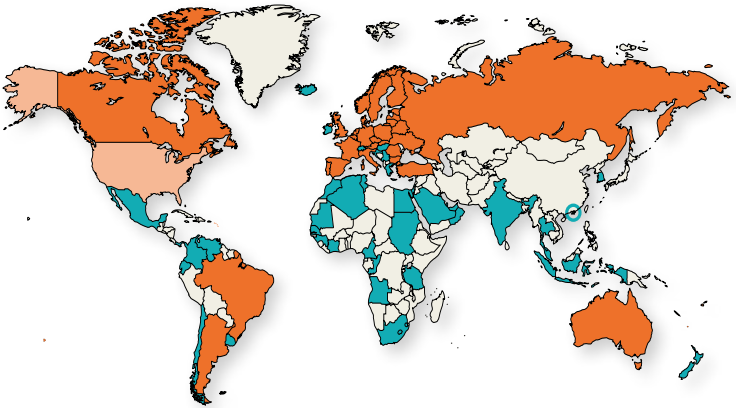
- Founded in 1968, more than 45 years of experience in the tail lift business
- Europe's N° 1 manufacturer of tail lifts, with production in excess of 35,000 units per year and more than 550,000 units sold since 1968
- Unparalleled product range with lift capacities ranging from 150 to 16,000 kg, all developed via internal growth
- Production sites in 5 countries
- Extensive vertical integration and technological leadership: more than 90% of mechanical, hydraulic and electrical parts used are manufactured in-house
- Professional network of DHOLLANDIA Area Sales & Service Centres (Europe) and independent distributors (outside Europe) in 6 continents and more than 60 countries worldwide



 DHOLLANDIA Group  Independent distributor



See www.dhollandia.com for our worldwide network.



6 good reasons to buy DHOLLANDIA



1- Safe & reliable



- No electronic components, exceptionally reliable
- Adapted to the intensive use and heavy duty work
- Strong & robust 4-cylinder tail lifts (*)
- Electrical safety valves mounted to all cylinders (*)
- Manual emergency back-up operation on all electro valves
- Level ride plus automatic tilt at ground level on most commercial lift models (*)



2- Flexible & client-oriented

- Small enough to care, big enough to cope
- Wide range of standard products ranging from 150 to 16,000 kg
- Extensive vertical integration and technological leadership: more than 90% of all mechanical, hydraulic and electrical parts used are manufactured in-house
- Therefore perfectly geared up to develop and manufacture tailor-made lifts and creative client-oriented solutions



3- Superior finish

- Low maintenance bearings and grease nipples in all critical articulation points
- Piston rods in hard-chromed stainless steel for all cylinders exposed to adverse weather conditions
- Best possible protection against corrosion: **HOT-DIP ZINC PLATED finish** or **Protection PLUS finish** on the majority of lifts

**HOT-DIP
ZINC PLATED**

KTL POWDER
painted + coated
Protection PLUS



4- Economic & budget friendly

- Optimum price-quality ratio
- Lifts designed to allow easy maintenance
- Attractive spare parts prices and low maintenance costs
- Longer life-time and durability



5- Strong environmental focus



- Use of Best Available Techniques in surface treatment and waste water treatment
- Use of rain water for industrial purposes
- Application of wind and solar energy to power manufacturing processes
- Maximum elimination of lost packaging material
- ISO 14001 certified



6- The safe and clever buy

- Modern lift range offering many safety features and functional options
- Professional service network in more than 60 countries across the world
- More than 550.000 units sold are the proof of customer satisfaction and loyalty
- Preferred choice of many transport companies, fleet-owners, rental companies and truck body manufacturers

(*) Generic characteristics for most types of commercial lifts

Best possible protection for your investment

DHOLLANDIA uses 2 premium surface treatment finishes for steel components, raising the quality and corrosion protection of the finished product to the absolute top in the tail lift industry.

Most popular commercial lifts are supplied in **HOT-DIP ZINC PLATED finish**, the less common lifts in **Protection PLUS finish**.



DHOLLANDIA's **Protection PLUS** paint finish combines innovative technologies to raise the quality and corrosion protection of its tail lifts to the highest level.

Protection PLUS incorporates 4 important steps:

1. Shot blasting of the steel substrate
2. 3-cation zinc phosphate
3. KTL cathodic dip epoxy coating (KTL = Katodische Tauch-Lackierung)
4. Polyester powder top coat

E-coat (KTL)



Polyester powder coat



HOT-DIP ZINC PLATING is based on the metallurgic bond between the steel parts and zinc, melted at 460 °C. The zinc-iron alloys formed in this way, offer a number of clear advantages:

**HOT-DIP
ZINC PLATED**

- ▶ **Best possible protection against corrosion**
- ▶ Improved metallurgic characteristics
- ▶ Better protection against shocks and wear
- ▶ Protects the outside **and inside** of steel structures (unlike e-coat or conventional paint systems, whose effect is limited to the painted outside surfaces)

Hot zinc melted at 460 °C



Green technology: life cycle assessments have proven that zinc-plating is the most environmentally friendly method of anti-corrosion protection.

Different types of RIDE

The **RIDE** of a lift describes the movement that its platform goes through when lowering from the vehicle floor to the ground; or vice versa when lifting from the ground to the vehicle floor.

DHOLLANDIA mainly uses 3 types of rides.

1 Wedge or conical platform Level ride + automatic tilt at ground level

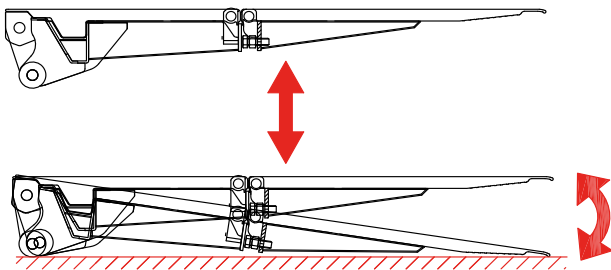

When lowering, the platform remains level from the vehicle floor down until the platform rollers touch the ground. Next, the platform tilts down to an inclined position that allows loading and unloading.

When lifting off the ground, the platform first tilts up from its inclined position on the ground to the horizontal level, then continues a level ride to the vehicle floor.

Recommended for:

- ▶ higher capacity applications, heavier loads
- ▶ applications where easy on- and off-loading of pallets with pallet jacks is required
- ▶ applications where adjustable platform orientation is required (tilt cylinders)

Used on:

DH-L and DH-S lifts, most DH-R lifts

② Half-dip ride

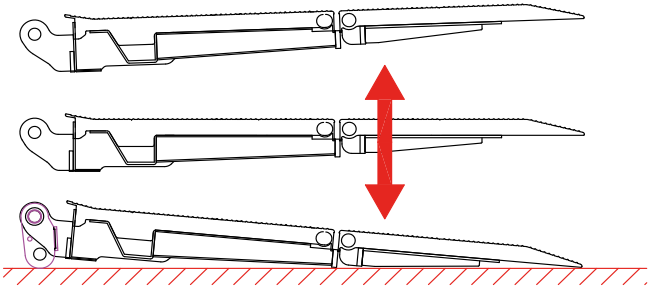

When lowering, the platform progressively tilts down from a level position at the vehicle floor to an inclined position at the ground. (And vice versa when lifting).

Recommended for:

- ▶ applications where the load is stable on the platform: parcels, tyres, boxes, white & brown goods, drums, etc...
- ▶ Low-budget, low-maintenance environment

Used on:

DH-RP lifts

③ Flat platform level ride

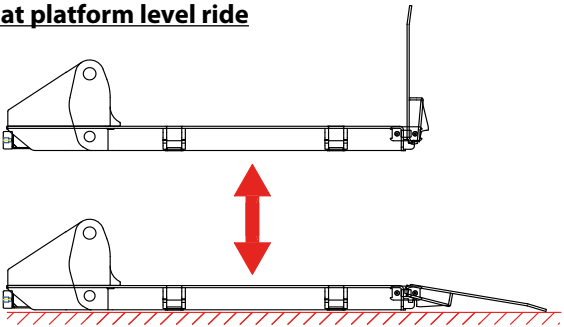

The platform remains level during the full lifting / lowering cycles. The rear end of the platform can be a fixed leading edge, or hinged ramps which adjust more easily to uneven surfaces.

Recommended for:

applications where the load is unstable on the platform: roll-cages, tall and top-heavy objects

Used on:

DH-LK and DH-SK lifts, most column lifts, most passenger lifts

Control units for all applications...



DHOLLANDIA offers a wide variety of different control units to suit particular lift models, special applications and the client's individual requirements. Instructions for mounting and risk analysis are available in the mounting instructions.

Most popular auxiliary controls



OAE001



OAE005



OAE011



OAE015



OAE060



E0452 / E0453

Most commonly used exterior control boxes

(conform with CE safety regulations, all exterior control boxes sold in Europe have mandatory 2-hand control)



OAE030.BT

Exterior control box with joy-stick, safety switch and main battery isolator switch



OAE031.Z (OAE035.Z)

3+1 button (or 4+1 button) control unit, integrated in the body panel, or mounted under the vehicle body, without isolator switch



OAE039.BP

Exterior control unit incorporated in the cover of the pump unit, with joy-stick, safety switch and main battery isolator switch



OAE041.BP

Arctic exterior control box with IP67 rated push buttons, safety switch and main battery isolator switch



OAE043.BT

Slim-line arctic exterior control box with IP67 rated toggle switches and main battery isolator switch



... and an endless list of options to choose from



DHOLLANDIA offers an almost endless list of electrical, hydraulic and mechanical options to fine-tune the lift to the client's individual requirements.

The most popular options involve:

- ▶ Control & ergonomics: various main and auxiliary controls
- ▶ Visibility: flashing platform lights & flags
- ▶ Load handling: roll-stops for pallets and roll cages
- ▶ Stability: hydraulic and mechanical stabilising legs
- ▶ Access: side loading ramps
- ▶ Operator safety: safety rails and fall protection, anti-slip platform surface finish & coatings
- ▶ Installation: quick-fit mounting solutions, plug & play connections
- ▶ Independence: battery & charging systems
- ▶ Finish: HOT-DIP ZINC PLATING, Protection Plus or individualised RAL colour schemes

Professional service network

Original spare parts



DHOLLANDIA spare parts =
100% original
100% reliable
100% compatible

DHOLLANDIA lifts are being distributed in more than 60 countries worldwide, through a dedicated and professional network of DHOLLANDIA Area Sales & Service Centres and official independent distributors.

Each of these country distributors holds substantial stock of lifts and original spare parts and can support clients with:

- ▶ commercial and technical advice
- ▶ maintenance, repair and road-side assistance
- ▶ fitting and fitting assistance
- ▶ training on any of the subjects above and operator training

Reading help

Lift capacity

Hydraulic tail lifts are not designed to LIFT / LOWER weights corresponding to their nominal capacity over the full surface of the platform. The nominal capacity is valid at a certain distance or centre of gravity, measured behind the rear of the vehicle body. Behind that centre, which is marked on the platform, the maximum safe working load of any brand of tail lifts diminishes according to specific load diagrams supplied with the lift.

Since lifts are being sold in many capacities and with various centres of gravity, it may seem a difficult task to make an objective comparison. Therefore, the concept load moment combines the nominal lift capacity with the applicable centre of gravity. It allows us to compare the total performance of the machine and to get some appreciation of its ability to endure heavy duty conditions over a longer time period.

Load moment = lift capacity x centre of gravity

Example: 2 lifts with identical capacity but different centre of gravity:

Type DH-LM.20 :

CAP	CG	LM
1500 kg	750 mm	11.25 kNm
2000 kg	750 mm	15 kNm

Type DH-LM.30 :

CAP	CG	LM
1500 kg	1000 mm	15 kNm
2000 kg	1000 mm	20 kNm
2500 kg	1000 mm	25 kNm
3000 kg	1000 mm	30 kNm



$$2000 \text{ kg} \times 750 \text{ mm}$$
$$20 \text{ kN} \times 0.75\text{m} = 15 \text{ kNm}$$

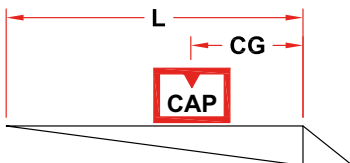

$$\text{LM} = \text{CAP} \times \text{CG}$$

CAP = nominal lift capacity
CG = centre of gravity
LM = load moment = CAP x CG

Units of measurement

Unless stated otherwise within the text, all weights are expressed in kg and all dimensions in mm.

Weight indications of the lifts

Weights:

STEEL platform	
1750 mm	? kg
2000 mm	? kg

ALU platform	
1800 mm	? kg
2000 mm	? kg

DHOLLANDIA lifts are available with a wide choice of different lift arms, lift frames and mounting plates, to allow integration to a wide variety of vehicles in optimum circumstances. Furthermore, most lifts are available with different platform designs and a long list of options to adapt the lift to the client's individual needs.

As a consequence, the weights mentioned in our sales literature are indicative and must be read : "from ... kg onwards". The real weights might vary according to the type of vehicle and the execution of the lift. Ask your national DHOLLANDIA distributor for further detail.

Voltage

Unless stated otherwise within the text, all systems mentioned are designed for 12V - 24V commercial vehicles. Other voltage systems are available on request.

Half width platforms, foldable platforms

All types of cantilever lifts (see chapter 3) are available with the standard platform, covering the full width of the vehicle body. But certain types are also available with half width or partial width platforms and vertically foldable platforms.

This possibility is indicated as follows:



Full width platform available



Half / partial width platform available



Half width frame + foldable platform available



Half / partial width platform not available



Half width frame + foldable platform not available



5

Fold-away lifts





→ Fold-away lift for light commercial vehicles

DH-RP.06 • 600 kg



The **DH-RP.06 600 kg** is the lightest lift of a new generation of efficiently designed, **light weight**, yet very strong fold-away tail lifts. These DH-RP lifts are equipped with a full aluminium platform, and feature a **half-dip platform ride** from the vehicle floor to the ground.

In its travel position, the DH-RP.06 is safely stored underneath the chassis of the vehicle. It is ideal for operations needing frequent fork lift (un)loading or access to loading docks, and offers free access to the cargo space at all times. It is **very easy to use**, and has **minimal impact on the vehicle pay-load**; hence it is ideal for the occasional use and for rental fleets.

The DH-RP.06 is designed for utility and commercial vehicles up to 7.5T GVW.

Lift capacity

CAP	CG	LM
600 kg	600 mm	3.6 kNm

Weights [see pg. 15]

ALU / ALU platform	
950x1500 mm	150 kg
1050x1500 mm	165 kg

Weights incl. CE bumper

The lightest and most compact of fold-away lifts

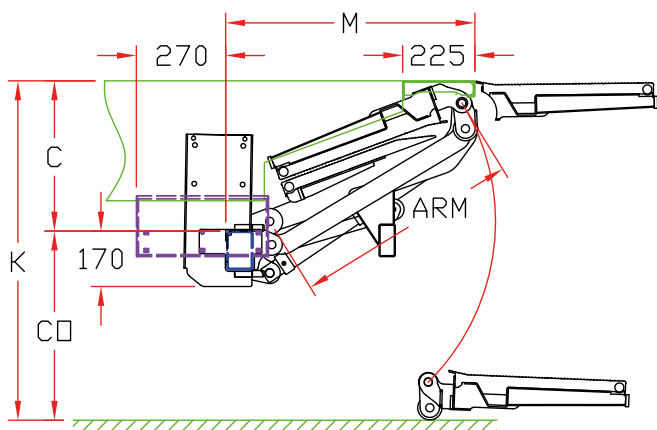

Fitting dimensions

ARM		700
K max.		1050
K min. loaded	V = 950 / 1050	770 / 820
C max.		465
C min.	V = 950 / 1050	300 / 350
CO max.		585
M	at C max.	765
M	at C min. for V = 950 / 1050	860 / 840
V max.		1050

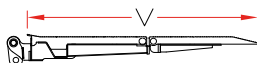

Technical specifications

Lift frame	120 x 80 mm
Cylinders	1 lift cylinder + 2 fixed stabilisers
Type of ride [see pg. 8-9]	Half dip ride, progressive inclination while lifting / lowering
Platform material	Alu / Alu
Standard platform depths	950 - 1050 mm
Standard platform widths	1500 - 2000 mm Other widths on request (option OAP303)
Lift arm lengths	700 mm
Lift arm widths	565 mm
Mounting	<ul style="list-style-type: none"> • Flat floor extension plate (OAM004) • Cranked floor extension plate (OAM005)
Standard control unit [see pg. 11]	OAE030.BT
Standard finish of the lift frame	Hot-dip zinc plated finish [OAT104]



→ Fold-away lift for light commercial vehicles

DH-RP.10 • 1000 kg



The **DH-RP.10 1000 kg** is the strongest of 2 lifts forming a new generation of light weight yet robust fold-away lifts with **half-dip platform ride** from the vehicle floor to the ground.

In its travel position, the DH-RP.10 is safely stored underneath the chassis of the vehicle. It is ideal for operations needing frequent fork lift (un)loading or access to loading docks, and offers free access to the cargo space at all times. It is **very easy to use**, and has **minimal impact on the vehicle pay-load**; hence it is ideal for the occasional use and for rental fleets.

The DH-RP.10 is designed for commercial vehicles up to 12T GVW. In standard configuration, its operation is gravity-down. **Power-down** (double acting descend) is available as an option for the harshest winter conditions (option OAH025.1).

Lift capacity

CAP	CG	LM
1000 kg	600 mm	6 kNm

Weights [see pg. 15]

ALU / ALU platform	
1050 mm	225 kg
1250 mm	235 kg

Weights incl. CE bumper

Light fold-away lift with half-dip platform ride

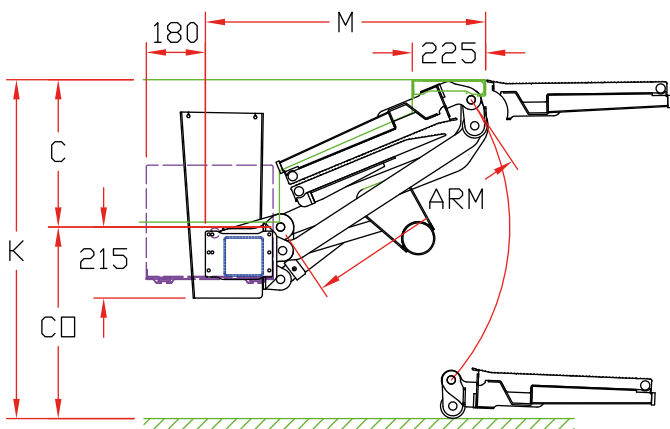

Fitting dimensions

ARM		700	800
K max.		1050	1170
K min. loaded		820	915
C max.		465	520
C min.		350	400
CO max.		585	650
M	at C max.	845	925
M	at C min.	920	1005
V max.		1050	1250

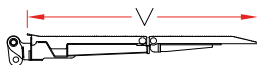

Technical specifications

Lift frame	120 x 120 mm
Cylinders	1 lift cylinder + 2 fixed stabilisers
Type of ride [see pg. 8-9]	Half dip ride, progressive inclination while lifting / lowering
Platform material	Alu / Alu
Standard platform depths	1050 - 1250 mm
Standard platform widths	1500 - 2000 mm Other widths on request (option OAP303)
Lift arm lengths	700 - 800 mm
Lift arm widths	565 mm
Mounting	<ul style="list-style-type: none"> • Flat floor extension plate (OAM004) • Cranked floor extension plate (OAM005)
Standard control unit [see pg. 11]	OAE030.BT
Standard finish of the lift frame	Hot-dip zinc plated finish [OAT104]



→ Fold-away lift for light commercial vehicles

DH-RC(C).10 • 750 - 1000 kg



The DH.RC.10 is DHOLLANDIA's best seller in the light duty fold-away lift range. In comparison to the DH-RP, this lift is equipped with a wedged platform, offering a **level ride from the vehicle floor to the ground** (and vice versa), including **automatic tilt at ground level**.

In its travel position, the DH-RC.10 is safely stored underneath the chassis of the vehicle. It is ideal for operations needing frequent fork lift (un)loading or access to loading docks, and offers free access to the cargo space at all times. It is **very easy to use**, and has **minimal impact on the vehicle pay-load**; hence it is ideal for the occasional use and for rental fleets.

There are 2 executions: the DH-RC.10 with fixed stabilisers and the DH-RCC.10 with tilt cylinders and **adjustable platform orientation**.

Lift capacity

CAP	CG	LM
750 kg	600 mm	4.5 kNm
1000 kg	600 mm	6 kNm

Weights [see pg. 15]

ALU / ALU platform	
1080 mm	275 kg
1280mm	285 kg

Weights incl. CE bumper

Light fold-away lift with level-ride platform

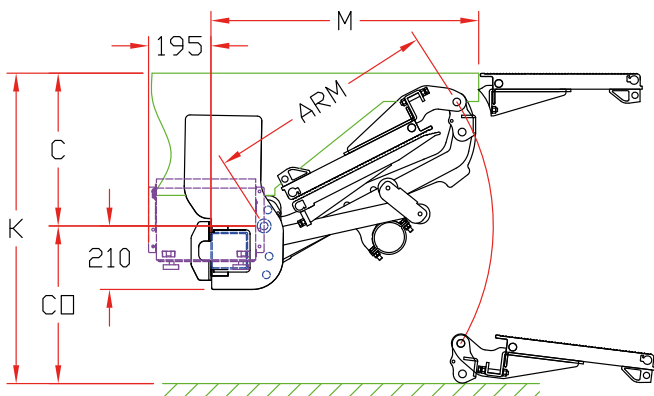

Fitting dimensions

ARM		750	850
K max.		1180	1310
K min. loaded		900	1000
C max.		580	660
C min.		350	400
CO max.		600	650
M	at C max.	810	895
M	at C min.	980	1070
V max.		1080	1280

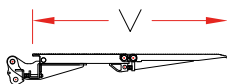

Technical specifications

Lift frame	120 x 120 mm
Cylinders	1 lift cylinder + 2 tilt cylinders (DH-RCC) or 2 fixed stabilisers (DH-RC)
Type of ride [see pg. 8-9]	Wedged platform, level ride with automatic tilt at ground level
Platform material	Alu / Alu
Standard platform depths	1080 - 1280 mm
Standard platform widths	2000 - 2200 mm Other widths on request (option OAP303)
Lift arm lengths	750 - 850 mm
Lift arm widths	600 mm
Mounting	<ul style="list-style-type: none"> • With floor plate (option OAM003) • Adapted for refrigerated floor (option S409)
Standard control unit [see pg. 11]	OAE030.BT
Standard finish of the lift frame	Protection PLUS [OAT102]



→ Fold-away lift for trucks, trailers & semi-trailers

DH-RC.15 • 1000 - 1500 kg



The DH-RC.15 is the ideal fold-away lift for **medium-duty** commercial vehicles. It is equipped with a wedged platform, offering a **level ride from the vehicle floor to the ground** (and vice versa), including **automatic tilt at ground level**.

In its travel position, the DH-RC.15 is safely stored underneath the chassis of the vehicle. It is ideal for operations needing frequent fork lift loading or access to loading docks, and all applications requiring quick and free access to the cargo space. The relatively short platforms of fold-away lifts are more recommended for roll cages, white and brown goods, parcels, etc... than for pallet work.

The DH-RC.15 is only available with fixed stabilisers, not with tilt cylinders. In standard configuration, its operation is gravity-down. **Power-down** (double acting descend) is available as an option for the harshest winter conditions (option OAH025.1).

Lift capacity

CAP	CG	LM
1000 kg	600 mm	6 kNm
1500 kg	600 mm	9 kNm

Weights [see pg. 15]

ALU / ALU		STEEL / ALU	
1250mm	358 kg	1250mm	395 kg
1450 mm	368 kg	1450 mm	415 kg

Weights incl. CE bumper

Medium capacity fold-away lift

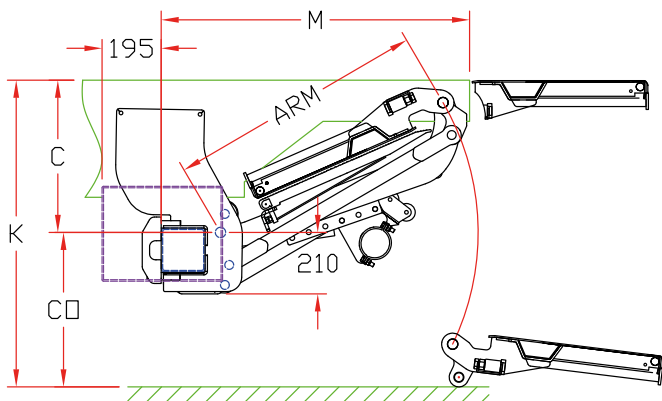

Fitting dimensions

ARM		880	980
K max.		1385	1510
K min. loaded		1010	1105
C max.		745	860
C min.		450	450
CO max.		640	650
M	at C max.	870	905
M	at C min.	1120	1230
V max.		1250	1450

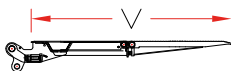

Technical specifications

Lift frame	150 x 150 mm
Cylinders	1 lift cylinder + 2 fixed stabilisers
Type of ride [see pg. 8-9]	Wedged platform, level ride with automatic tilt at ground level
Platform material	Steel / Alu • Alu / Alu
Standard platform depths	(1150) - 1250 - 1450 mm
Standard platform widths	2000 - 2200 mm Other widths on request (option OAP603)
Lift arm lengths	880 - 980 mm
Lift arm widths	500 mm
Mounting	<ul style="list-style-type: none"> • With floor plate (option OAM003) • Adapted for refrigerated floor (option S409)
Standard control unit [see pg. 11]	OAE030.BT
Standard finish of the lift frame	Protection PLUS [OAT102]



→ Fold-away lift for trucks, trailers & semi-trailers

DH-RM(C).20 • 1000 - 2000 kg



The DH-RM.20 is equipped with a robust lift frame, a wide arm center and 2 lift cylinders. Hence it serves the **heavy-duty end of the fold-away lift market**. It is equipped with a wedged platform, offering a level ride from the vehicle floor to the ground (and vice versa), including **automatic tilt at ground level**.

In its travel position, the DH-RM.20 is safely stored underneath the chassis of the vehicle. It is ideal for operations needing frequent fork lift loading or access to loading docks, and all applications requiring quick and free access to the cargo space. The relatively short platforms of fold-away lifts are more recommended for roll cages, white and brown goods, parcels, etc... than for pallet work.

There are 2 executions: the DH-RM.20 with fixed stabilisers, and the DH-RMC.20 with tilt cylinders and **adjustable platform orientation**.

The special model DH-RMV.20 is specially designed for trucks with a **draw-bar coupling** (for central-axle trailers).

Lift capacity

CAP	CG	LM
1000 kg	600 mm	6 kNm
1500 kg	600 mm	9 kNm
2000 kg	600 mm	12 kNm

Weights [see pg. 15]

ALU / ALU		STEEL / ALU	
1150 mm	410 kg	1150 mm	433 kg
1250mm	415 kg	1250mm	440 kg
1450 mm	425 kg	1450 mm	455 kg

Weights incl. CE bumper

Heavy duty fold-away lift with 2 lift cylinders

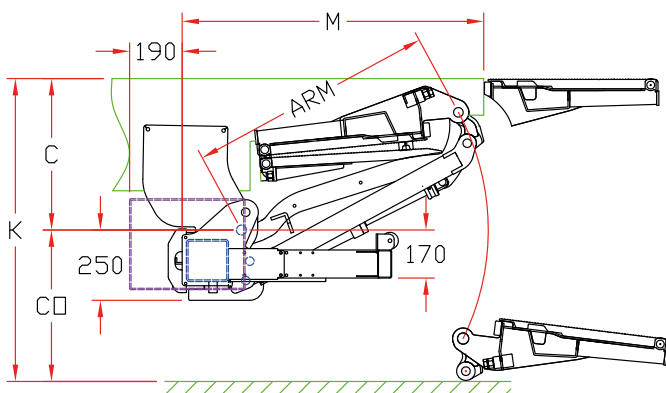

Fitting dimensions

ARM		880	1000	1050 (*)
K max.		1390	1560	1660
K min. loaded		1000	1110	1210
C max.		720	815	910
C min.		500	500	400
CO max.		670	745	750
M	at C max.	940	1050	970
M	at C min.	1125	1260	1300
V max		1250	1450	1600 (*)

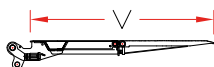

(*) For 2000 kg - 1600 mm, it is strongly recommended to use the model DH-RM.25

Technical specifications

Lift frame	150 x 150 mm
Cylinders	2 lift cylinders + 2 tilt cylinders (DH-RMC) or 2 fixed stabilisers (DH-RM)
Type of ride [see pg. 8-9]	Wedged platform, level ride with automatic tilt at ground level
Platform material	Steel / Alu • Alu / Alu
Standard platform depths	1150 - 1250 - 1450 - 1600 mm 1600 mm on special request (*)
Standard platform widths	2000 - 2200 mm 2350 mm on request (option OAP603)
Lift arm lengths	880 - 1000 - 1050 (*) mm
Lift arm widths	1150 - 1400 mm
Mounting	<ul style="list-style-type: none"> • With floor plate (option OAM003) • Adapted for refrigerated floor (option S409)
Standard control unit [see pg. 11]	OAE030.BT
Standard finish of the lift frame	Protection PLUS [OAT102]



→ Fold-away lift for trucks with trailer coupling

DH-RMV(C).20 • 1000 - 2000 kg



The fold-away lift DH-RMV.20 is derived from the DH-RM.20, and is specially adapted to suit **trucks with a draw-bar coupling** (for central-axle trailers).

- The lift frame is custom made in function of the chassis and coupling dimensions (option OAU008).
- The lift is equipped with an **articulated bumper bar** (option OAF132), that can be lowered to legal bumper height when the truck drives SOLO, and can be lifted out of the way when the trailer is COUPLED to the truck.

There are 2 executions: the DH-RM.20 with fixed stabilisers, and the DH-RMC.20 with tilt cylinders and **adjustable platform orientation**.

Lift capacity

CAP	CG	LM
1000 kg	600 mm	6 kNm
1500 kg	600 mm	9 kNm
2000 kg	600 mm	12 kNm

Weights [see pg. 15]

ALU / ALU		STEEL / ALU	
1150 mm	430 kg	1150 mm	440 kg
1250mm	435 kg	1250mm	450 kg
1450 mm	445 kg	1450 mm	465 kg

Weights incl. CE bumper

For truck-trailer combinations with draw bar



Fitting dimensions

See fitting dimensions type DH-RM.20 on page 137

Technical specifications

See technical specifications type DH-RM.20 on page 137



→ Fold-away lift for trucks, trailers & semi-trailers

DH-RM.25 • 1500-2500 kg



The **DH-RM.25** is DHOLLANDIA's most powerful fold-away tail lift. The long 1600 mm full-aluminium platform offers 1500-2500 kg lift capacity, and is specially adapted to offer **maximum reliability in the harshest winter conditions**, incl. **POWER DOWN** operation.

The DH-RM.25 is mounted with a reinforced vehicle bed extension plate, further equipped with **2 sturdy dock-bumpers** with adjustable ladders. In its travel position, the tail lift is safely stored underneath the chassis of the vehicle. Hence it is **ideal for frequent dock or fork lift loading operations**, for the occasional use, and for all applications where a quick and free access to the vehicle cargo space is required.

The DH-RM.25 is primarily designed for heavy-duty trucks and semi-trailers. The tail lift is **compatible with most common DOCK-LOCK vehicle restraint systems**.

Lift capacity

CAP	CG	LM
1500 kg	750 mm	11.25 kNm
2000 kg	750 mm	15 kNm
2500 kg	750 mm	18.75 kNm

Weights [see pg. 15]

ALU / ALU	
1600 mm	585 kg
Floor ext. + bumpers	165 kg

Weights incl. CE bumper

Powerful robust fold-away lift adapted to the harshest winter conditions

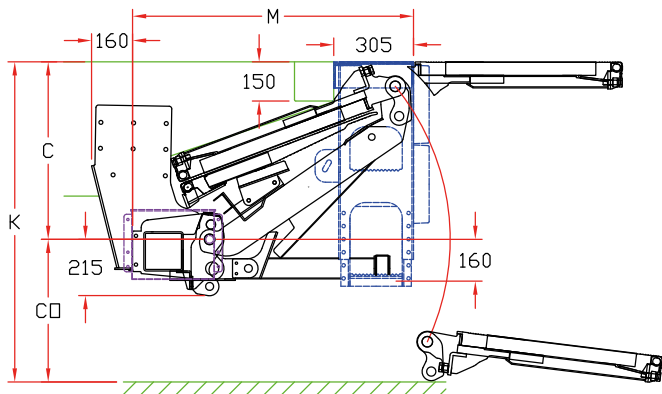

Fitting dimensions

ARM		920
K max.		1520
K min.		1200
CT max.		745
CT std.		650
COT max.		800
M	at CT max.	990
M	at CT std.	1070
V max		1600

Technical specifications

Lift frame	150 x 150 mm
Cylinders	2 double acting lift cylinders (POWER DOWN) + 2 fixed stabilisers
Type of ride [see pg. 8-9]	Wedged platform, level ride with automatic tilt at ground level
Platform material	Alu / Alu
Standard platform depths	1600 mm
Standard platform widths	2150 mm for 2430 mm wide extension plate 2300 mm for 2590 mm wide extension plate
Lift arm lengths	920 mm
Lift arm widths	1400 mm
Mounting	<ul style="list-style-type: none"> • Heavy duty floor plate (option OAM041) • 2 sturdy dock-bumpers with adjustable ladders (option OAM042)
Standard control unit [see pg. 11]	OAE041.BP arctic control box
Standard finish of the lift frame	Hot-dip zinc plated finish [OAT104]



→ Side mounted fold-away lift for trucks, trailers & semi-trailers

DH-REK.10 • 1000 kg



The DH-REK is a bespoke fold-away lift, adapted for **fitting at the side** of commercial vehicles. It enables to load and unload merchandise through the side doors of the body.

The solid arm construction with 1 central lift cylinder guarantees maximum platform stability. The platform is equipped with automatic tilt at ground level.

The relatively short platforms are more recommended for roll cages and parcels, than for pallet work.

Lift capacity

CAP	CG	LM
1000 kg	600 mm	6 kNm

Weights [see pg. 15]

ALU / ALU	
1100 mm	425 kg
1400 mm	440 kg

For use at the side doors

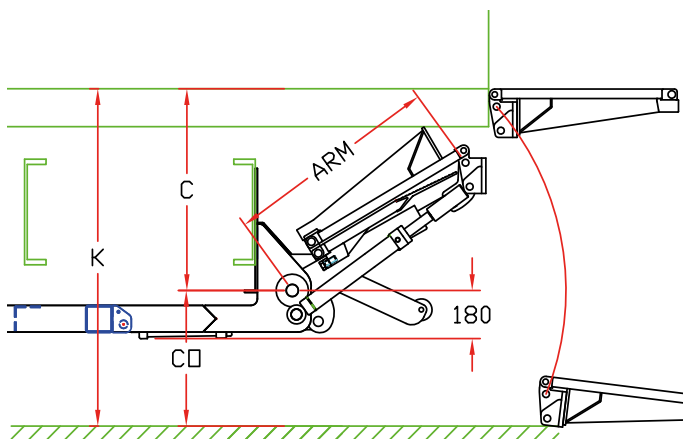

Fitting dimensions

ARM		940	1020
K max.		1350	1410
C max.		680	705
C min.		study req.	
CO max.		670	720
M	at C max.	study req.	
M	at C min.	study req.	
V max		1100	1400

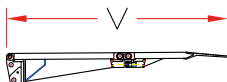

Technical specifications

Lift frame	Custom made lift frame, adapted for side mounting on vehicle chassis
Cylinders	<ul style="list-style-type: none"> • 1 central lift cylinder • 2 double acting tilt cylinders (partially hydraulic deployment of the platform)
Type of ride [see pg. 8-9]	Wedged platform, level ride with automatic tilt at ground level
Platform material	Alu / Alu
Standard platform depths	1100 - 1400 mm
Standard platform widths	1400 mm. Other widths (max. 1600mm) on request (OAP603)
Lift arm lengths	940 - 1020 mm
Lift arm widths	580 mm
Standard control unit [see pg. 11]	OAE030.BT
Standard finish of the lift frame	Protection PLUS [OAT102]

www.dhollandia.com



DHOLLANDIA

IZ E17-1072 Zoomstraat 9 • 9160 Lokeren • Belgium
Tel. +32 (0)9 349 06 92 • Fax +32 (0)9 349 09 77
www.dhollandia.com • info@dhollandia.be

DHOLLANDIA UK LTD

7 Latham Road • Huntingdon, Cambridgeshire
PE29 6YG • United Kingdom
Tel. +44 1480 435 266 • Fax +44 1480 431 823
info@dhollandia.com